

Single zone inverter mini split

MODEL: ELD12KCO15S

**WILLIS**

Job Name: \_\_\_\_\_

Location: \_\_\_\_\_

Engineer Name: \_\_\_\_\_

File  Resubmit

Contractor: \_\_\_\_\_

System No: \_\_\_\_\_

Approval  Other

Date: \_\_\_\_\_

**General Features**

- \* Smart 1 Hertz Inverter Techn
- \* Low Voltage Start-up
- \* Comfortable Sleep Mode
- \* Multiple Fan Speeds
- \* Dehumidify
- \* Memory Function
- \* Fan Delay Function
- \* Timer



**Unit Performance:**

<i>Cooling:</i>	
Capacity (Min-Rated-Max, Btu/h)	3,600-12,000-12,500
SEER	15
EER	9,23
<i>Heating:</i>	
Capacity (Min-Rated-Max, Btu/h)	N/A
HSPF	N/A
COP (W/W)	N/A

\*\*\*\*

**Unit Specification**

Refrigerant Type	R410A
Refrigerant Charge (oz)	35,3
ODU Sound Pressure (dB(A))	53
IDU Sound Pressure (dB(A))	44/42/39/36
ODU Net Weight (lbs)	65
IDU Net Weight (lbs)	22
Dehumidifying (Pint/h)	2,96

*Fan*

ODU / IDU Type	Axial-flow/Cross-flow
Quantity (ODU + IDU)	1+1
Motor/Drive	Direct Drive
ODU Max Air Flow Rate (CFM)	2720
IDU Air Flow Rate (CFM)	335/277/253/218

**Compressor**

Cooling Operation Ambient temp. Range	64~109 °F
Heating Operation Ambient temp. Range	N/A
Compressor Type	Rotary
Fan Motor Output (W)	21
Crankcase Heater	No

**Electrical Specification**

Power Supply	208-230V / 60Hz
Communications Wire Size	/
MOP (A)	15
MCA (A)	10
Cooling Rated Amps (A)	9
Heating Rated Amps (A)	N/A
Compressor RLA (A)	7,3
Indoor Fan Motor RLA (A)	0,2
Outdoor Fan Motor RLA (A)	0,25
Nominal Cooling Power Input (kW)	1,3
Nominal Heating Power Input (kW)	N/A

*Piping*

Liquid Line (in, OD)	1/4
Gas Line (in, OD)	3/8
Additional Refrigerant (oz./ft.)	0.2
Max Pipe Length (ft.)	65.6
Piping Length (no add'l refrigerant, ft.)	24.6
Max Elevation (ft.)	32.8



Capacity Variation Ratio According to Temperature

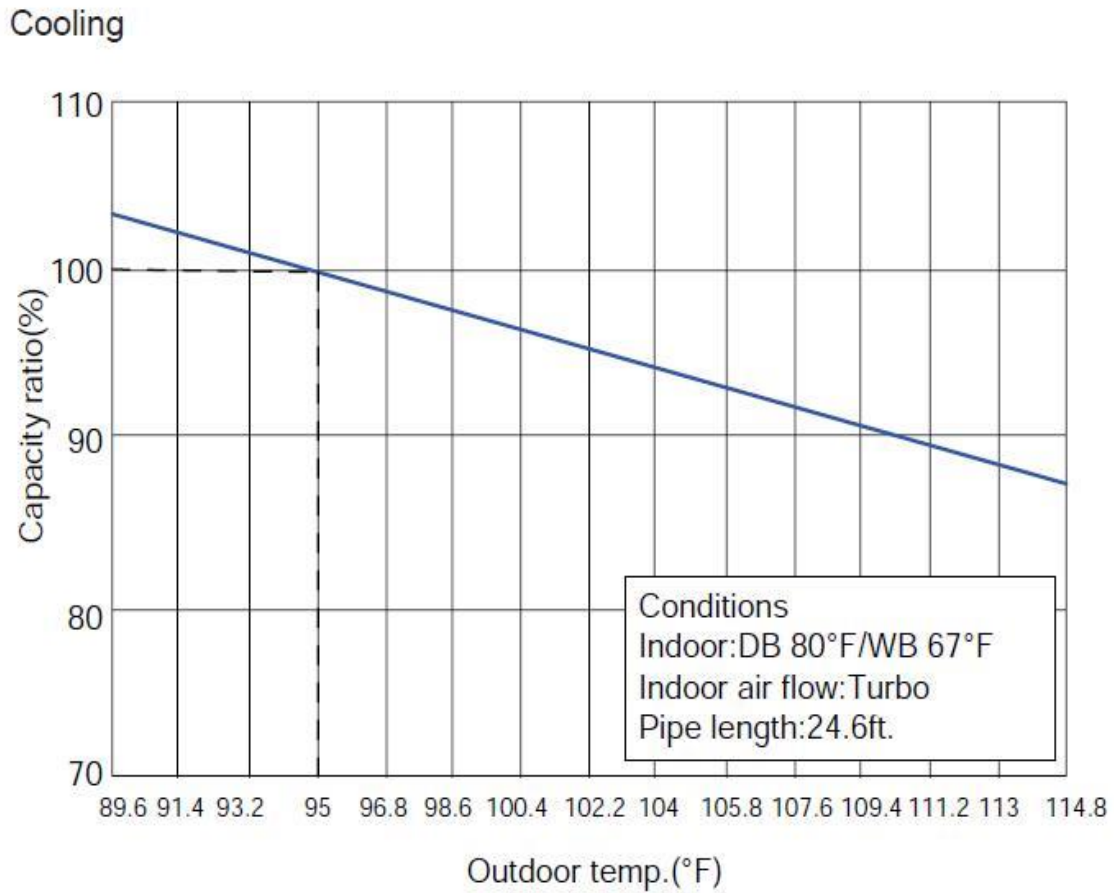

Single zone inverter mini split

MODEL: ELD12KCO15S

**WILLIS**

**Outline Dimension Diagram**

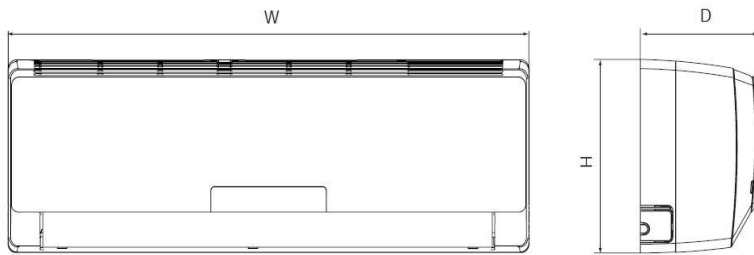

Unit: Inch	
W:	33 2/7
H:	10 4/5
D:	7

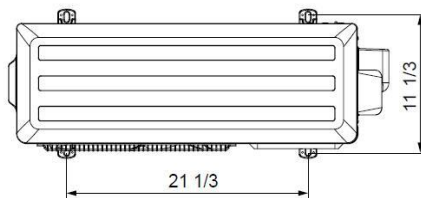
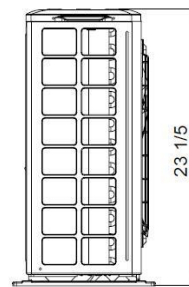
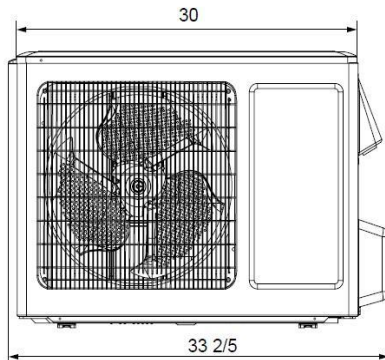
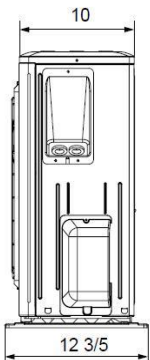
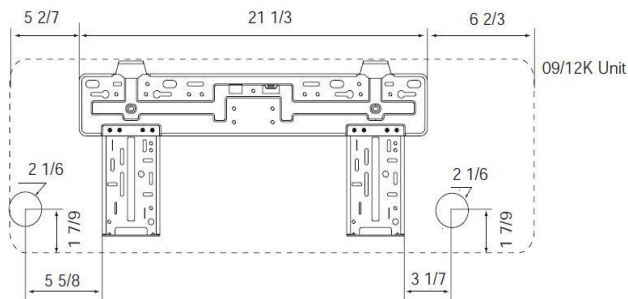

Unit:inch



**GLOSSARY**

SEER - Seasonal Energy Efficiency Ratio

EER - Energy Efficiency Ratio

HSPF - Heating Seasonal Performance Factor

MOP - Maximum Overcurrent Protection

MCA - Minimum Circuit Ampacity

5965 Chemin de la Côte de Liesse  
Saint laurent, QC, Canada, H4T 1C3

Contact: +1 438 792 1956

[info@willishvac.com](mailto:info@willishvac.com)

[www.willishvac.com](http://www.willishvac.com)