

Light Commercial

MODEL I/O: LCF48KCH16S - LCO48KCH16S



Job Name: _____

Location: _____

Engineer Name: _____

File Resubmit

Contractor: _____

System No: _____

Approval Other

Date: _____

General Features

- Compact Design
- Wide Discharge Range
- Microcomputer Control
- Easy Maintenance
- Flexible Installation
- Comfortable Airflow



Unit Performance:

<i>Cooling:</i>	
Capacity (Min-Rated-Max, Btu/h)	20,400-48,000-50,500
SEER	16
EER	9.7
<i>Heating:</i>	
Capacity (Min-Rated-Max, Btu/h)	17,500-54,500-61,500
HSPF	9
COP (W/W)	3.48

Unit Specification

Refrigerant Type	R410A
Refrigerant Charge (oz)	141.12
ODU Sound Pressure (dB(A))	59
IDU Sound Pressure (dB(A))	56/50/46
ODU Net Weight (lbs)	231.5
IDU Net Weight (lbs)	130.1
Dehumidifying (Pint/h)	4.2

Fan

ODU / IDU Type	Axial-flow/Centrifugal
Quantity (ODU + IDU)	2+4
Motor/Drive	Direct Drive
ODU Max Air Flow Rate (CFM)	3880
IDU Air Flow Rate (CFM)	1350

Compressor

Cooling Operation Ambient temp. Range	0~115 °F
Heating Operation Ambient temp. Range	0~75 °F
Compressor Type	Inverter Rotary
Fan Motor Power Output (HP)	1/6 x 2
Crankcase Heater	Yes

Electrical Specification

Power Supply	208-230V / 60Hz
Communications Wire Size(ODU/IDU)	AWG 10/17
MOP (A)	70
MCA (A)	45
Cooling Rated Amps (A)	34.27
Heating Rated Amps (A)	34.27
Compressor RLA (A)	32.5
Indoor Fan Motor Full Load Amp (A)	4
Outdoor Fan Motor Full Load Amp (A)	2 x 2
Nominal Cooling Power Input (kW)	5.15
Nominal Heating Power Input (kW)	5.15

Piping

Liquid Line (in, OD)	3/8
Gas Line (in, OD)	5/8
Additional Refrigerant (oz./ft.)	0.6
Max Pipe Length (ft.)	164
Piping Length (no add'l refrigerant, ft.)	25
Max Elevation (ft.)	98.4

AHRI Certification Ref # 8950347





Cooling Performance F / %

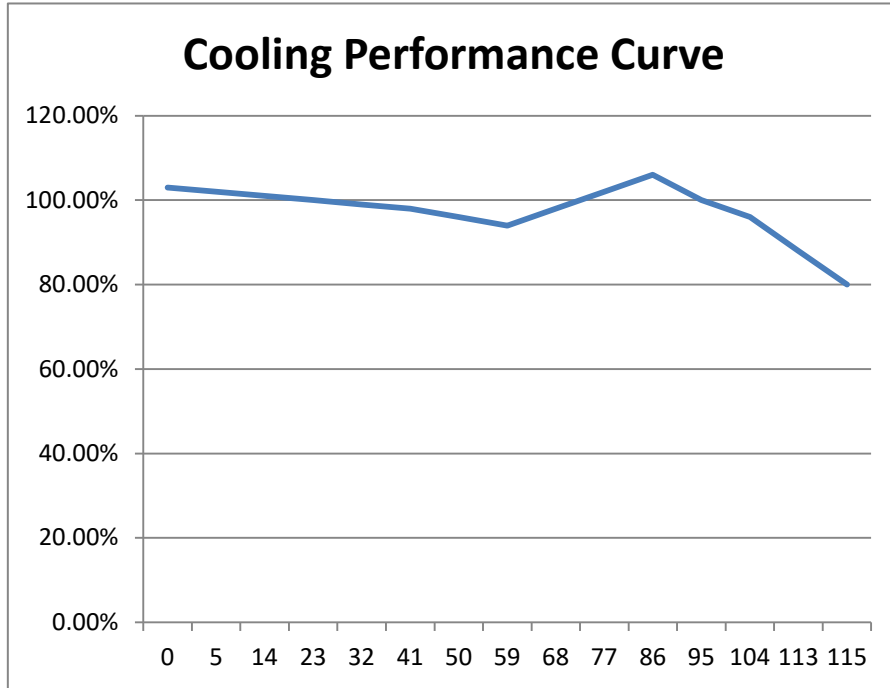

Heating Performance F / %

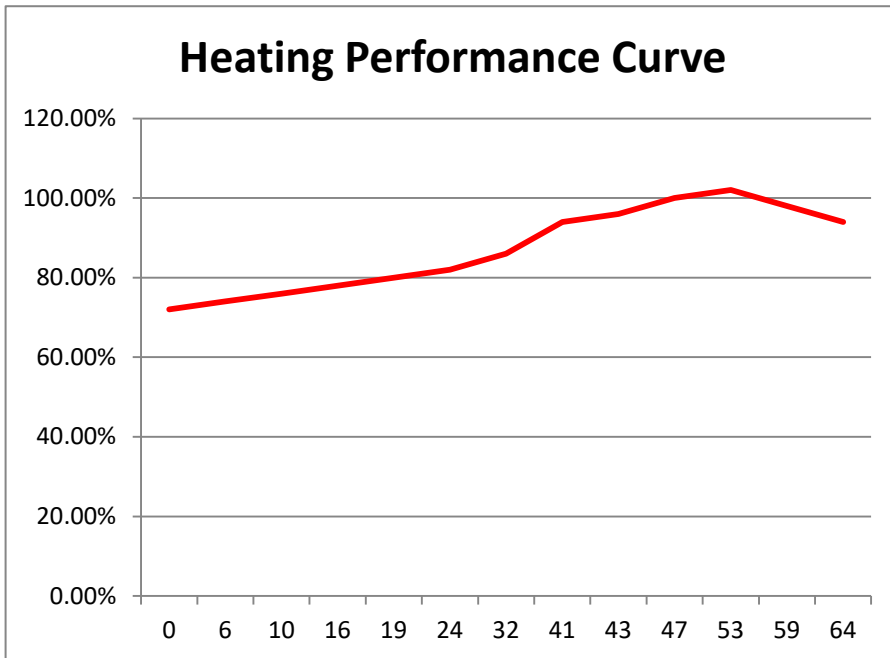

Light Commercial

MODEL I/O: LCF48KCH16S - LCO48KCH16S



Outline Dimension Diagram

	mm	(inch)
A	1700	(66-7/8)
B	245	(9-5/8)
C	1634	(64-3/8)
D	280	(11)
H	700	(27-1/2)

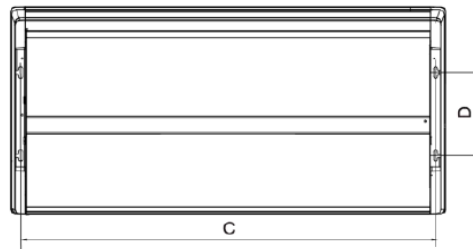
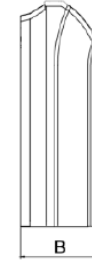
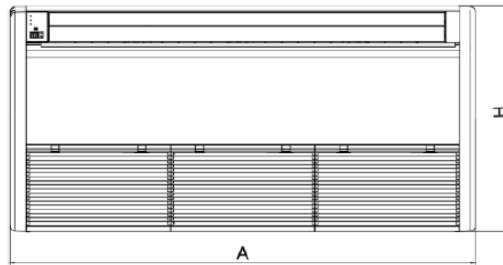

A	958	(37-3/4)
B	412	(16-1/4)
C	1349	(53-1/8)
D	572	(22-1/2)
E	376	(14-3/4)

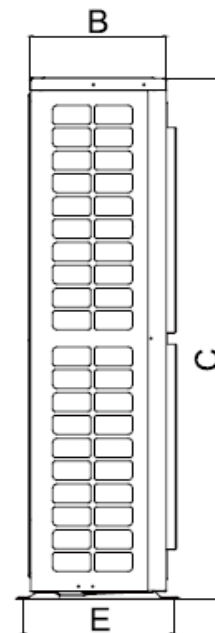
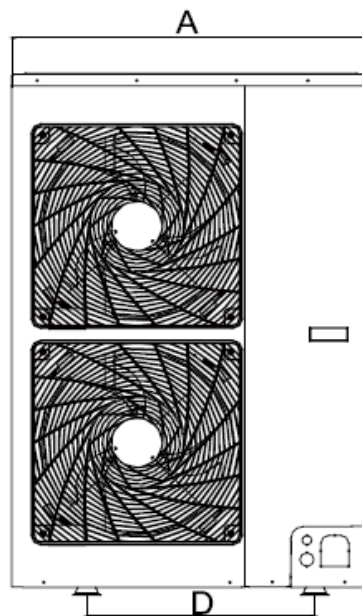

GLOSSARY

SEER - Seasonal Energy Efficiency Ratio

EER - Energy Efficiency Ratio

HSPF - Heating Seasonal Performance Factor

MOP - Maximum Overcurrent Protection

MCA - Minimum Circuit Ampacity



5965 Chemin de la Côte de Liesse
Saint laurent, QC, Canada, H4T 1C3

Contact: +1 438 792 1956

info@willisac.com

www.willisac.com