

Light Commercial

MODEL I/O: LCF42KCH16S - LCO42KCH16S



Job Name: _____

Location: _____

Engineer Name: _____

File Resubmit

Contractor: _____

System No: _____

Approval Other

Date: _____

General Features

- Compact Design
- Wide Discharge Range
- Microcomputer Control
- Easy Maintenance
- Flexible Installation
- Comfortable Airflow



Unit Performance:

| | |
|---------------------------------|----------------------|
| <i>Cooling:</i> | |
| Capacity (Min-Rated-Max, Btu/h) | 12,000-39,500-42,500 |
| SEER | 16 |
| EER | 9.75 |
| <i>Heating:</i> | |
| Capacity (Min-Rated-Max, Btu/h) | 13,000-44,000-52,500 |
| HSPF | 9 |
| COP (W/W) | 3.21 |

Unit Specification

| | |
|----------------------------|----------|
| Refrigerant Type | R410A |
| Refrigerant Charge (oz) | 130.54 |
| ODU Sound Pressure (dB(A)) | 61 |
| IDU Sound Pressure (dB(A)) | 55/52/47 |
| ODU Net Weight (lbs) | 209.5 |
| IDU Net Weight (lbs) | 110.3 |
| Dehumidifying (Pint/h) | 3.4 |

Fan

| | |
|-----------------------------|------------------------|
| ODU / IDU Type | Axial-flow/Centrifugal |
| Quantity (ODU + IDU) | 2+3 |
| Motor/Drive | Direct Drive |
| ODU Max Air Flow Rate (CFM) | 3880 |
| IDU Air Flow Rate (CFM) | 1115 |

Compressor

| | |
|---------------------------------------|-----------------|
| Cooling Operation Ambient temp. Range | 0~115 °F |
| Heating Operation Ambient temp. Range | 0~75 °F |
| Compressor Type | Inverter Rotary |
| Fan Motor Power Output (HP) | 1/6 x 2 |
| Crankcase Heater | Yes |

Electrical Specification

| | |
|-------------------------------------|-----------------|
| Power Supply | 208-230V / 60Hz |
| Communications Wire Size(ODU/IDU) | AWG 10/17 |
| MOP (A) | 50 |
| MCA (A) | 31 |
| Cooling Rated Amps (A) | 24.55 |
| Heating Rated Amps (A) | 24.81 |
| Compressor RLA (A) | 21.2 |
| Indoor Fan Motor Full Load Amp (A) | 2.1 |
| Outdoor Fan Motor Full Load Amp (A) | 2 x 2 |
| Nominal Cooling Power Input (kW) | 4.15 |
| Nominal Heating Power Input (kW) | 3.9 |

Piping

| | |
|---|------|
| Liquid Line (in, OD) | 3/8 |
| Gas Line (in, OD) | 5/8 |
| Additional Refrigerant (oz./ft.) | 0.6 |
| Max Pipe Length (ft.) | 164 |
| Piping Length (no add'l refrigerant, ft.) | 25 |
| Max Elevation (ft.) | 98.4 |

AHRI Certification Ref # 8950344





Cooling Performance F / %

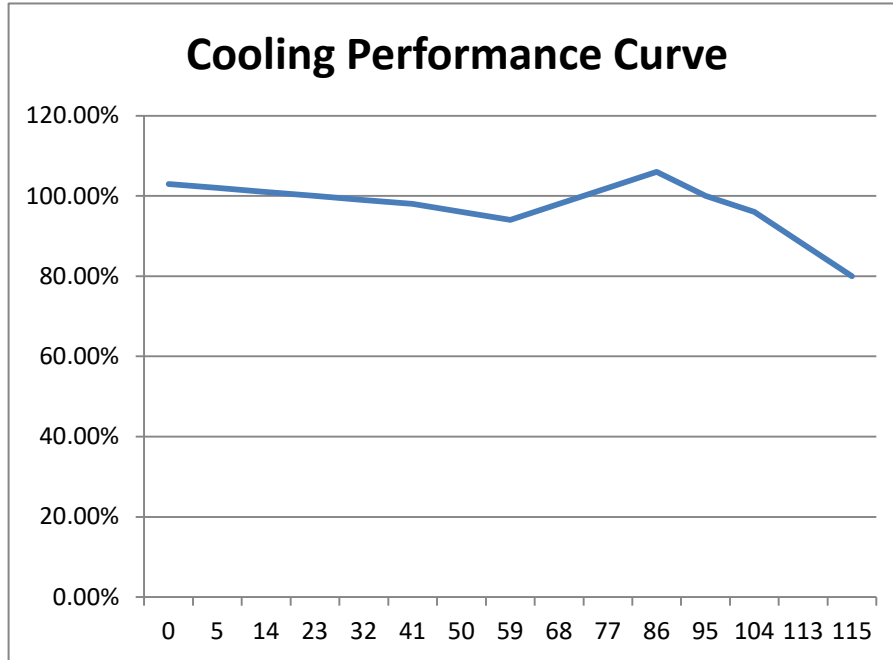

Heating Performance F / %

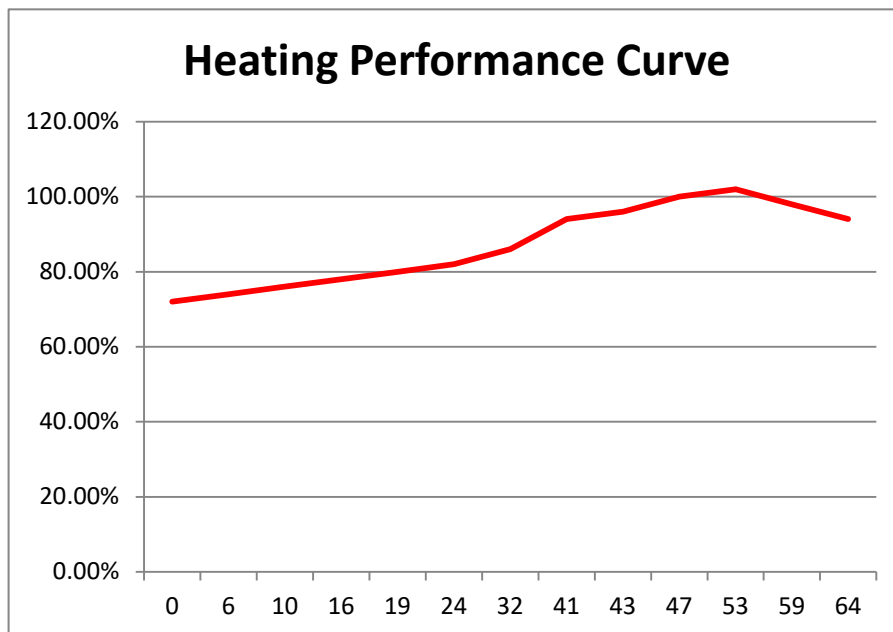

Outline Dimension Diagram

| | mm | (inch) |
|---|------|----------|
| A | 1420 | (55-7/8) |
| B | 245 | (9-5/8) |
| C | 1354 | (53-1/4) |
| D | 280 | (11) |
| H | 700 | (27-1/2) |

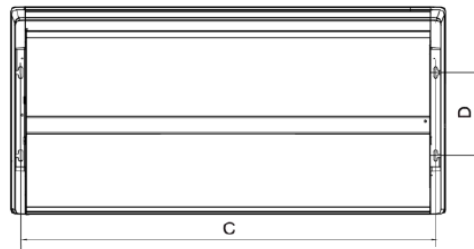
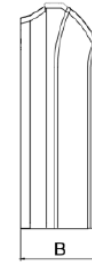
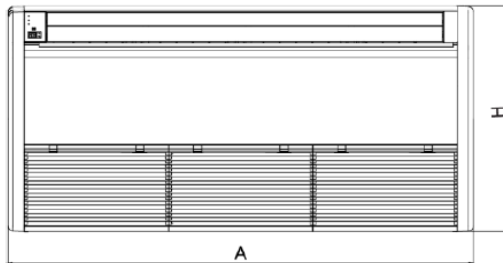

| | | |
|---|------|----------|
| A | 958 | (37-3/4) |
| B | 412 | (16-1/4) |
| C | 1349 | (53-1/8) |
| D | 572 | (22-1/2) |
| E | 376 | (14-3/4) |

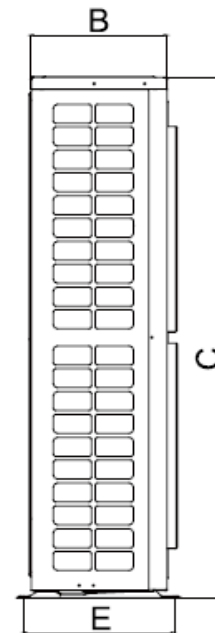
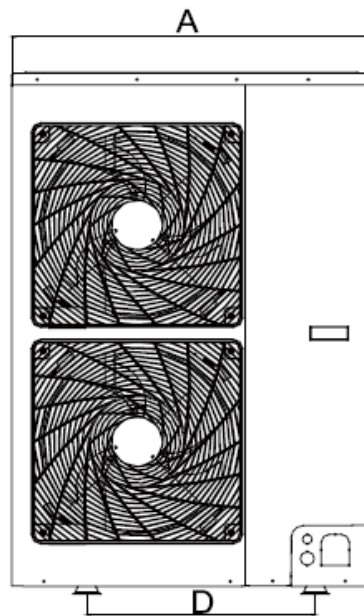

GLOSSARY

SEER - Seasonal Energy Efficiency Ratio

EER - Energy Efficiency Ratio

HSPF - Heating Seasonal Performance Factor

MOP - Maximum Overcurrent Protection

MCA - Minimum Circuit Ampacity



5965 Chemin de la Côte de Liesse
Saint laurent, QC, Canada, H4T 1C3

Contact: +1 438 792 1956

info@willisac.com

www.willisac.com